



## Pilgrims Walk, Worthing, BN13 1RJ

Asking Price £130,000

Being sold with no onward chain, this well-presented first-floor studio flat offers its own private entrance, allocated parking and excellent storage, making it an ideal first purchase or investment.

The property has been updated and improved by the current owner and now provides comfortable and practical accommodation ready to move into. The bright open-plan living space benefits from built-in storage and a large window allowing plenty of natural light. The fitted kitchen provides ample cupboard and worktop space, while the modern bathroom is well appointed with useful vanity storage.

Further benefits include no service charge, a peppercorn ground rent and access to a generous loft space providing additional storage.

The property is conveniently situated close to local shops and amenities and within easy reach of West Worthing railway station, making it ideal for commuters and those looking for a well-located and low-maintenance home.



Council Tax Band: A

- Leasehold with approx. 954 years remaining
- Ground Rent – Annual Peppercorn
- Well presented throughout
- Modern fitted kitchen and bathroom
- Convenient for West Worthing station

- Service and Maintenance Charge – £0
- Being sold with no onward chain
- Private entrance and allocated parking
- Close to local shops and amenities
- Ample storage including loft access



Worthing, a picturesque seaside town on the south coast of England, exudes a unique charm with its blend of Victorian elegance and contemporary vitality. Known for its extensive pebble beach, historic pier, and well-maintained promenade, Worthing offers residents and visitors alike a captivating coastal experience. The town's vibrant cultural scene is enriched by theatres, art galleries, and frequent events, creating a lively atmosphere. With its beautiful parks, such as Beach House Park and Highdown Gardens, Worthing provides green spaces for leisure and relaxation. The town's bustling town centre features a diverse array of shops, restaurants, and entertainment venues, contributing to its reputation as a welcoming and thriving community. Worthing's accessibility, rich history, and scenic beauty make it a sought-after destination for those seeking a coastal haven with a perfect blend of tradition and modernity.

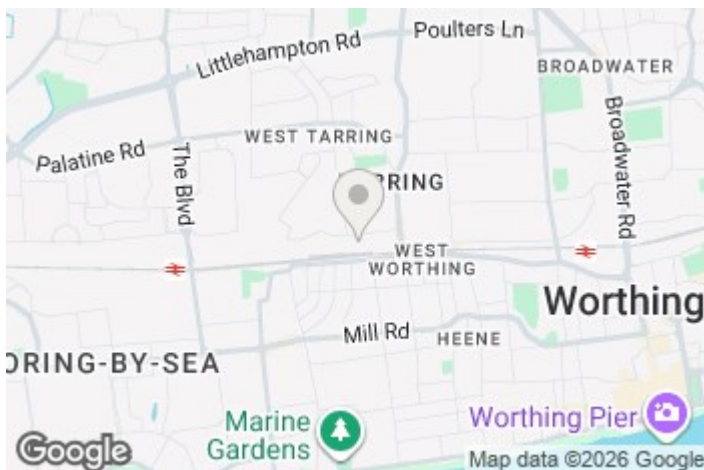

EPC Rating:

C

Energy Efficiency Rating		
	Current	Potential
Very energy efficient - lower running costs		
(92 plus) <b>A</b>		
(81-91) <b>B</b>		
(69-80) <b>C</b>	75	78
(55-68) <b>D</b>		
(39-54) <b>E</b>		
(21-38) <b>F</b>		
(1-20) <b>G</b>		
Not energy efficient - higher running costs		
<b>England &amp; Wales</b>	EU Directive 2002/91/EC	

## First Floor

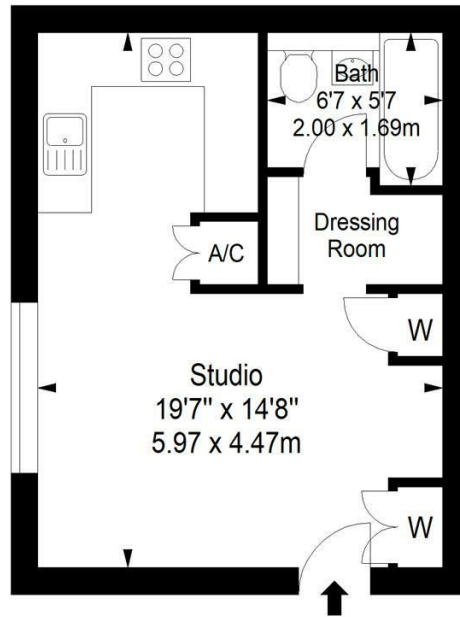

Approximate gross internal floor area 26.7 sq m/ 287.4 sq ft

Whilst every care has been taken to ensure accuracy, dimensions are approximate and for illustrative purposes only.  
All rights reserved.

### Aspire Residential | Goring-by-Sea

28 Goring Road  
Goring-by-Sea  
Worthing  
BN12 4AD  
Telephone: 01903 259 961  
Email: [info@aspireresidential.co.uk](mailto:info@aspireresidential.co.uk)



### Aspire Residential | Durrington / Salvington

5 Selden Parade  
Salvington Road  
Worthing  
BN13 2HL  
Telephone: 01903 910 424  
Email: [enquiries@aspireresidential.co.uk](mailto:enquiries@aspireresidential.co.uk)

Aspire Residential and Aspire Residential Estate Agents are trading names of Aspire Residential Sales Limited, a Company registered in England and Wales with registration number 11659289. VAT No. 317450614

IMPORTANT NOTICE TO PURCHASERS: We endeavour to make our sales particulars accurate and reliable, however, they do not constitute or form part of an offer or any contract and none is to be relied upon as statements of representation or fact. The services, systems and appliances listed in this specification have not been tested by us and no guarantees as to their operating ability or efficiency are given. All measurements have been taken as a guide to prospective buyers only, and are not precise. If you require clarification or further information on any points, please contact us, especially if you are traveling some distance to view.